

Miracle Mile Shopping Plaza

4925 Jackman Road | Toledo, OH 43613

41.7053, -83.5883

Lucas County Toledo, OH 305,325 Sq Ft

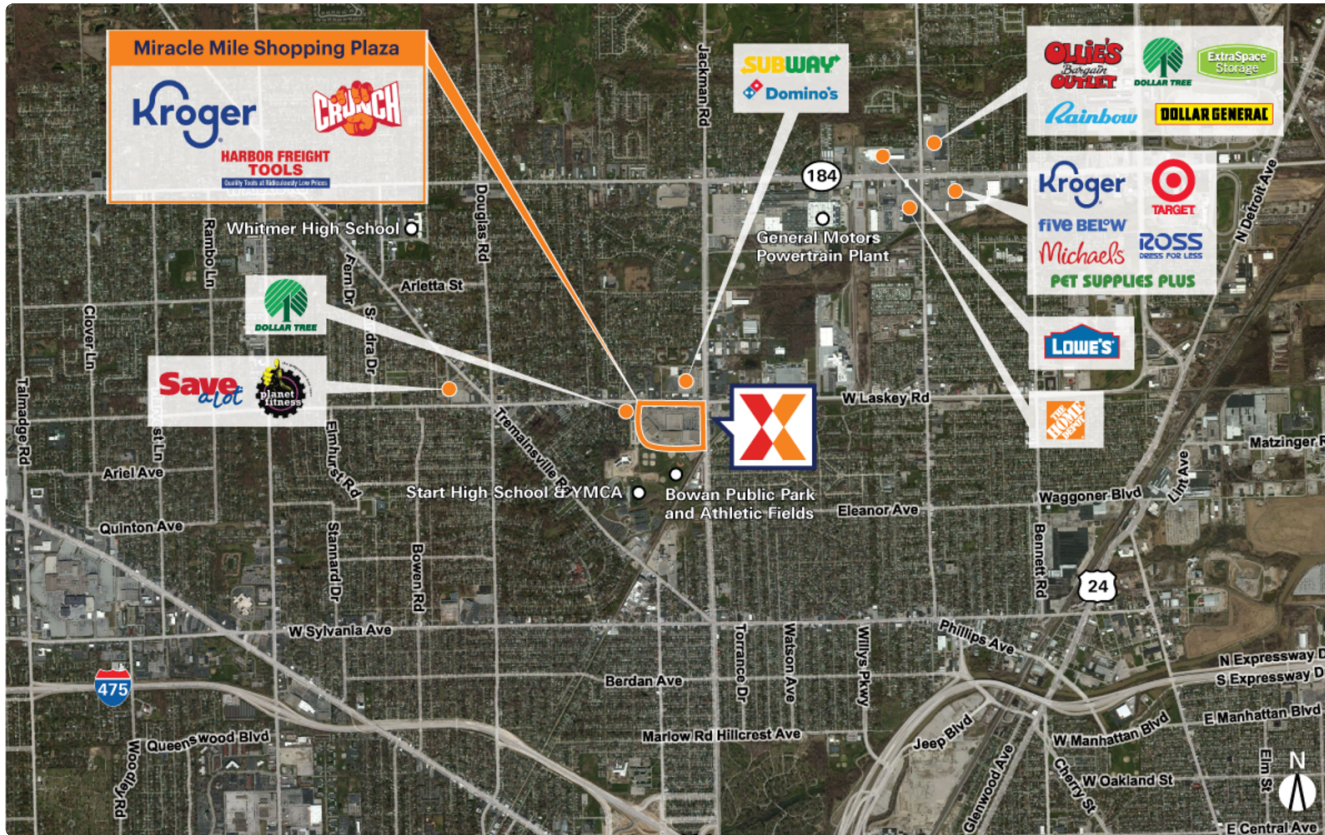

| Demographics | 1 Mile | 3 Miles | 5 Miles |
|--------------|----------|----------|----------|
| Population | 13,352 | 101,654 | 199,098 |
| Daytime Pop. | 10,944 | 83,305 | 240,418 |
| Households | 5,632 | 44,327 | 84,651 |
| Income | \$72,636 | \$76,805 | \$81,413 |

Source: Synergos Technologies, Inc. 2024

Ranked as Ohio's most highly trafficked shopping center, drawing an estimated 11K+ daily visits and 3.8M+ annually (Placer.ai 2024)

Excellent visibility from 17K+ vehicles daily on Jackman Rd and 15K+ on W Laskey Rd, with easy access from eight points of ingress/egress, including one signalized entrance (Kalibrate 2020)

Surrounded by a dense population of 101.4K+ within 3 miles

Directly adjacent to Start High School and Larchmont Elementary School with a combined enrollment of 1,660 students

Benefit from traffic draw of strong national retailers such as Kroger, Crunch Fitness, Harbor Freight Tools & Sally Beauty Supply



Miracle Mile Shopping Plaza

4925 Jackman Road | Toledo, OH 43613

Lucas County | Toledo, OH | 305,325 Sq Ft

41.7053, -83.5883



Available Spaces

| | | | | | |
|----|--------------|------|----|--------------|------|
| 04 | 3,000 Sq Ft | 360° | 15 | 39,618 Sq Ft | 360° |
| 09 | 3,300 Sq Ft | 360° | 19 | 5,250 Sq Ft | 360° |
| 10 | 4,500 Sq Ft | 360° | 20 | 23,000 Sq Ft | 360° |
| 11 | 4,500 Sq Ft | 360° | 27 | 5,000 Sq Ft | 360° |
| 13 | 4,500 Sq Ft | 360° | 31 | 3,000 Sq Ft | 360° |
| 14 | 10,000 Sq Ft | 360° | | | |

Current Tenants

Space size listed in square feet

| | | |
|-------|---------------------------------------|---------|
| 01 | Kroger | 106,128 |
| 03 | Lavish Me Spa | 2,025 |
| 05 | Great Clips | 3,000 |
| 06 | Rent-A-Center | 4,500 |
| 07 | Supreme Supplements | 1,800 |
| 08 | Crunch | 38,660 |
| 12 | Meraki Nail Spa | 2,000 |
| 16 | H&R Block | 2,250 |
| 17 | Sally Beauty Supply | 2,250 |
| 18 | Salon Strozie'r | 4,625 |
| 22 | DaVita | 7,091 |
| 28 | Harbor Freight Tools | 15,000 |
| 30 | Checkers/Rally's Drive-In Restaurants | 738 |
| 32 | Tim Hortons | 3,030 |
| FUEL | Kroger Fuel Center | 0 |
| NAP01 | McDonald's | 3,500 |
| NAP02 | Discount Computer Repair | 0 |
| NAP03 | Wendy's | 3,060 |

This site plan is for illustrative and information purposes only, showing the general layout of the shopping center; and is not a legal survey. Brixmor makes no representation or warranty that the shopping center is exactly as depicted as site conditions and tenant mix are subject to change over time.
3034

